

Existing Site Layout 1:100

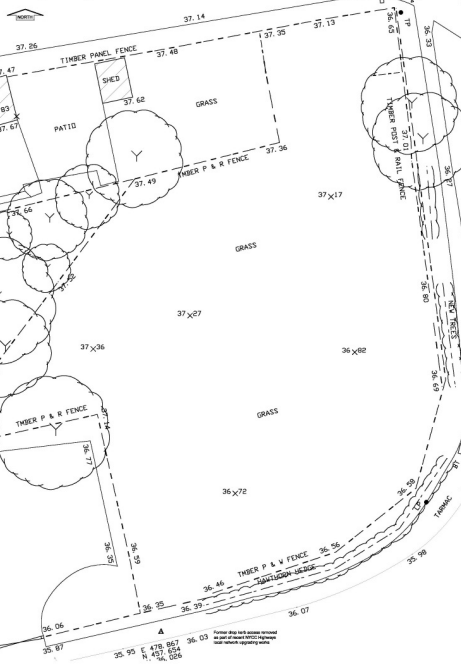

Proposed Site Layout 1:100

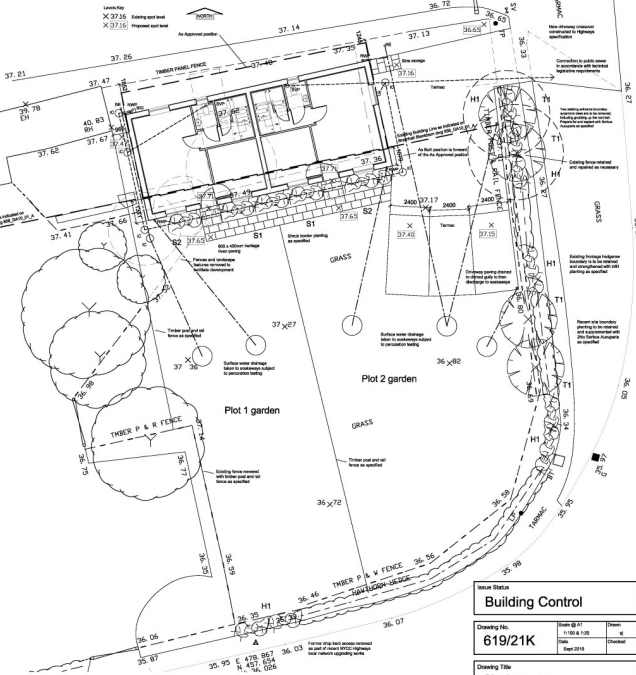

Landscape Proposal

Shrub Planting
 All shrubs to be 100cm tall and to be evenly spaced at a density of 2 per sqm.
 All shrub planting to be planted in the proposed beds with 100cm spacing. Fertiliser and mulch to be applied to the beds in accordance with the manufacturer's instructions. Bed size to be as indicated on the plan.

Shrub to be planted in approximately equal quantities throughout the development. Without these trees planted in proposed areas, the site will not be considered as a garden.

Shrub to be planted with European Foliage 'Rondelet' and 'Rondelet' and 'Rondelet' ground cover.

Hedgeplanting
 Hedging to be 100cm tall and evenly spaced at 100cm intervals. Hedging to be planted in the proposed beds with 100cm spacing. Fertiliser and mulch to be applied to the beds in accordance with the manufacturer's instructions. Bed size to be as indicated on the plan.

Trees
 The site will be planted with European Foliage 'Rondelet' and 'Rondelet' trees. The trees to be planted in the proposed beds with 100cm spacing. Fertiliser and mulch to be applied to the beds in accordance with the manufacturer's instructions. Bed size to be as indicated on the plan.

Lawn Areas
 All lawn areas to be prepared for grass seed and grass seed to be sown. The lawn to be sown in the proposed areas with 100cm spacing. Fertiliser and mulch to be applied to the lawn in accordance with the manufacturer's instructions. Bed size to be as indicated on the plan.

General Requirements
 All garden and planting areas to be in accordance with the manufacturer's instructions. The garden to be prepared for grass seed and grass seed to be sown. The lawn to be sown in the proposed areas with 100cm spacing. Fertiliser and mulch to be applied to the lawn in accordance with the manufacturer's instructions. Bed size to be as indicated on the plan.

Material Schedule
Walling Stone - Natural limestone to appear like limestone
Artstone - white, black & grey, hard exterior door backs - Yorkshire
Roof Covering - Natural clay tiles and ridge
Rainwater Goods - Black iron rain water gutters and down pipes
External Doors - 100cm wide, black exterior door and frame in accordance with SAP and App D1.1 requirements
Windows - Painted timber frames in accordance with SAP and App D1.1 requirements
Parking Area and Spaces - Black tarmac sealed to automotive standards
Paths and Paving - 100cm wide, 100mm thick

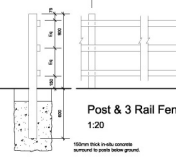

Post & Rail Fence 1:20

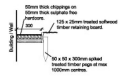

Mowing Strip 1:20



Building Control	
Drawing No.	619/21K
Issue	1
Date	12/11/20
Drawn by	JD
Checked by	JD

Site Layouts	
Client	Mr S Benson

Proposed Dwellings	
Building Plots	
Forkers Lane / Chapel Road	
Settlington	

Jenkinson Associates Ltd
 Chartered Architect
 May Cottage
 Mill Lane
 Skelton Road
 York
 YO42 4NE
 Tel: 01759 318200
 www.jenkinsonassociates.co.uk
 e-mail: enquiries@jenkinsonassociates.co.uk

Rev K - As Approved position information added - 30/11/16 - GJ
 Rev J - Building position amended to as built - 20/11/15 - GJ
 Rev I - Not used to avoid confusion
 Rev H - North points added - 26/11/15 - GJ
 Rev G - As Built 1/15, and associated proposed levels - 21/11/15 - GJ
 Rev F - Topo information not introduced - 20/11/15 - GJ
 Rev E - As Built boundary lines added to proposed site layout, closed off access route added to both site layouts - 20/11/15 - GJ
 Rev D - Topo information not introduced - 03/11/15 - GJ
 Rev C - This planing introduced, the information removed from proposed site layout - 03/11/15 - GJ
 Rev B - Topo information not introduced - 23/11/14 - GJ
 Rev A - As Built boundary topo information corrected, topo information removed from proposed site layout - 07/10/14 - GJ

THIS DRAWING IS THE PROPERTY OF JENKINSON ASSOCIATES LTD. IT IS TO BE USED ONLY FOR THE PROJECT AND SITE SPECIFICALLY IDENTIFIED HEREON. IT IS NOT TO BE REPRODUCED, COPIED, EITHER WHOLLY OR IN PART, OR TRANSMITTED IN ANY FORM OR BY ANY MEANS, WITHOUT THE WRITTEN PERMISSION OF JENKINSON ASSOCIATES LTD.